

MARYLEBONE · W1

MARYLEBONE

village.

High Street boutiques. Michelin stars.
Sunday farmers' market. Regent's Park.
Where central London feels like a village.

A Eat & Drink

B Shop & Culture

C Active

D Practicals

CUI

CITY & URBAN INTERNATIONAL

Eat & Drink

A

Michelin stars, village cafes, Sunday market. High street dining.



■ FINE DINING & MICHELIN

01

AngloThai

22-24 Seymour Place, W1H

John & Desiree Chantarasak Michelin star 2025. Thai-British tasting menu. Seasonal British ingredients, Thai techniques. Lunch £65, dinner £125. Hottest table 2024.

02

Trishna

15-17 Blandford Street, W1U

Coastal Indian, Michelin star. Sethi siblings (Gymkhana team). Whole Dorset crab signature. Tandoori lamb chops. Eye-wateringly expensive but exceptional. Special occasions.

03

Kol

22 Seymour Place, W1H

Santiago Lastra refined Mexican. Fine dining, not stuffy. Clay pots, seasonal English ingredients. Spicy mezcal margarita. Michelin star.

04

The Hart

Chiltern St / Blandford St

Public House Group (Pelican/Hero). Moody corner spot. Banoffee pie legendary. Downstairs pub, upstairs dining room. Bruern Farms produce. Scene-y.



RESTAURANTS

01

Donostia

Marylebone Village

Basque tapas, pintxos. Sibling Lurra across road. Top pintxos, perfect tortilla, txakoli wine. San Sebastian transported.

02

Hoppers

Marylebone

Best Sri Lankan London. Bone marrow varuval, kothu roti. Pandan Negroni. More spacious than Soho original. Two floors, outdoor tables.

03

Carlotta

Marylebone High Street

Italian classics, lavish interiors. Tagliolini black truffle must-order. Reasonable W1 prices. Art-deco bar aperitivo.

04

Fischer's

Marylebone High Street

Viennese cafe-restaurant. Schnitzel, apple strudel. All-day dining. Tables spill outside. Popular locals spot.



■ CAFES & BRUNCH

01

Ottolenghi

Marylebone Lane

Deli + restaurant. Vibrant salads, shakshuka, pastries. All-day, no reservations. Daily changing dishes.

02

Granger & Co

Marylebone

Australian brunch specialist. Bill Granger recipes. Ricotta hotcakes famous. Fresh, healthy, Instagrammable.

03

La Fromagerie

Moxon Street

Cheese heaven. Shop + cafe. Cheese boards carefully sourced, themed by nation. French tableware. Slice of paradise.

04

Nordic Bakery

Marylebone

Best cinnamon buns London. Swedish fika culture. Simple, clean, hygge. Hot tea/coffee. Local favorite.

SUNDAY FARMERS' MARKET

Marylebone Farmers' Market 10am-2pm Sundays. Quiet parking lot off High Street. Fresh produce, organic eggs, pastries, cheeses, flowers, paella cooked to order. Local favorite. Only organic UK produce. Brings village alive weekends.

Shop & Culture

B

Daunt Books. Wallace Collection. Independent boutiques. Village shopping.

■ SHOPPING & BOUTIQUES

01

Daunt Books

Marylebone High Street

World's oldest custom-built bookshop 1912. Long oak galleries, stunning skylight. Travel books massive collection. Most beautiful bookstore London. Edwardian touches, paradise bookworms.

02

The White Company

Marylebone High Street

British linens, homeware. Clean minimalist aesthetic. Bedding, candles, bath products. Gift everything flat needs.

03

The Conran Shop

Marylebone High Street

Famous furniture, design. Curated homeware, lighting. Terence Conran legacy. Stylish, considered pieces.

04

Whistles

Marylebone High Street

Born Marylebone. Contemporary fashion. Laid-back meets luxury. Duchess Cambridge fan. Classic contemporary cool.



■ CULTURE & MUSEUMS

THE WALLACE COLLECTION

Hertford House, Manchester Square. FREE entry. 25 galleries French paintings, furniture, art 15th-19th centuries. Hals Laughing Cavalier. Titian, Velazquez, Rembrandt Titus portrait, Fragonard The Swing. French 18th-century decorative arts world's finest. Armoury collection spectacular. Courtyard restaurant photogenic, glamorous. Quieter alternative big museums. Human-scale, soft light, old masters people actually return to. Hidden gem historic townhouse. Lady Wallace bequeathed British nation 1897, open since 1900.

WIGMORE HALL

World-famous concert hall. Chamber music, song recitals. Acoustics legendary. Intimate 550-seat venue. Sunday morning coffee concerts popular. Pre/post-concert dining nearby. Classical music heart London.

SHERLOCK HOLMES MUSEUM

221b Baker Street. Fictional detective brought life. Meticulously decorated rooms pay homage stories. Victorian-era details. Popular tourist attraction. 10 minutes High Street.

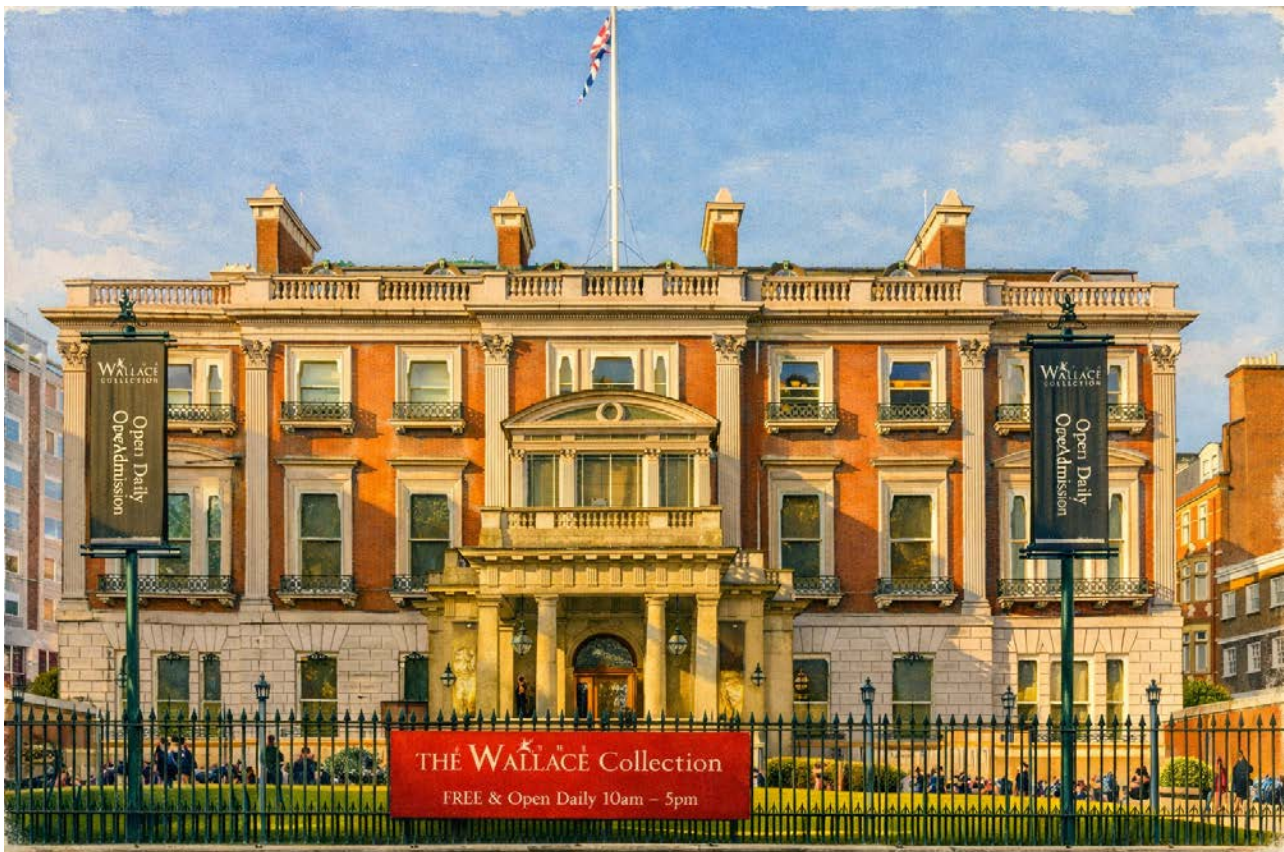

Active

C

Regent's Park. Queen Mary's Gardens. 400 acres green escape.



■ REGENT'S PARK

REGENT'S PARK

Nearly 400 acres luxurious green. Arguably prettiest Royal Parks London. Gardens, fountains, picturesque lake, 12,000+ roses. Short stroll north Marylebone Village. Queen Mary's Gardens spring/summer color explosion. Boating lake paddle boats. Open Air Theatre summer performances. Primrose Hill northern edge best London skyline views. Morning jogs, leisurely strolls, picnics perfect. Tree-lined paths autumn golden leaves. ZSL London Zoo northern end. John Nash terraces stunning white stucco surrounding. Park Crescent residents exclusive private park access. 10-minute walk High Street. One London's most beautiful outdoor spaces.

GYMS & FITNESS

Third Space Marylebone (luxury gym, pool, spa). Nuffield Health Moorgate. Various boutique studios yoga/pilates. Running: Regent's Park circuits popular. Walking: village streets pedestrian-friendly, Marylebone Lane winding historic. Cycling: Santander Cycles available.

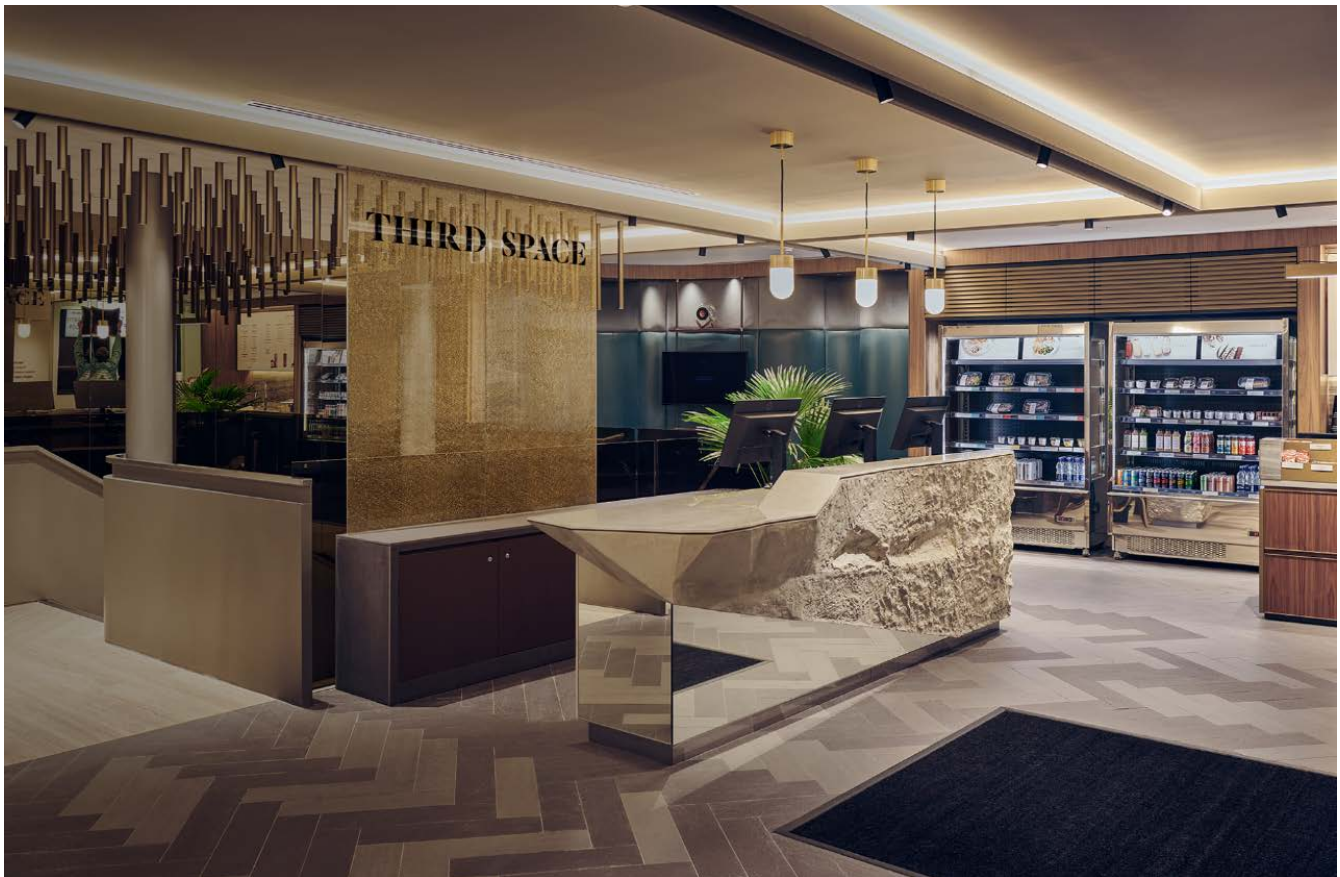

Practicals

D

Transport, character. Where village meets central London.

VILLAGE IN CITY

Small-Town Feel

Cozy small European village within city. Steps from Selfridges/Oxford Street yet peaceful, polished, wonderfully walkable. Stone streets, fewer cars, quiet residential vibe. Old European charm wander feels dream. Boutique restaurants, stylish shops, flower stands, independent bookstores far more curated/relaxed than high-energy neighborhoods nearby. Nestled between Regent's Park tranquil lawns and Mayfair marvel. Favorite West London locals, largely unknown tourists. Small-town feel despite proximity bustling Oxford Street. Heart village runs Marylebone High Street dapper thoroughfare brimming photo-worthy facades.

ESTATE STEWARDSHIP

Howard de Walden

Long-term estate stewardship keeps high street cohesive, pretty, low vacancy. Window-shopping feels edited rather than algorithmic. Village identity not accident. Most retail/leisure properties owned managed Howard de Walden Estate. Preserving/enhancing neighborhood character. Well-maintained environment, supportive landlord, vibrant local community values quality/individuality. Steady flow affluent customers plus tourists drawn unique shopping/cultural experience. Unlike more crowded/commercialized shopping districts, refined/loyal clientele appreciate premium products/services.

MICHELIN DENSITY

Fine Dining Hub

High density Michelin star spots fashionable corner West End. Fine dining, relaxed neighbourhood restaurants, hot new openings hyped chefs side by side. AngloThai Michelin 2025. Trishna coastal Indian Michelin. Kol Mexican Michelin. Eye-wateringly expensive many, but absolutely delicious. Venture off Oxford Street seek meal remember. Whether peddling haute cuisine or down-to-earth fare, absolutely great restaurants packed here. Marylebone swankier districts, quaint streets teeming tourists/well-heeled locals.

CULTURAL TREASURES

Wallace & Wigmore

Wallace Collection FREE museum world's greatest art collections. 25 galleries French paintings/furniture 15th-19th centuries. Historic mansion heart Marylebone. Human-scale, people actually return. Wigmore Hall world-famous concert hall chamber music/song recitals. Acoustics legendary. 550-seat intimate venue. Sunday morning coffee concerts. Classical music heart. Cultural enthusiasts appreciate both magnificent offerings historic townhouse (Wallace) and intimate performance space (Wigmore). Proximity West End means world-class theatre/concerts entertainment short walk.

WEEKDAYS

Quiet Village

Mid-week mornings best quiet stores. High Street feels calm, pedestrian-friendly. Independent shops, cafes, professionals grabbing coffee. Ottolenghi lunch crowd. Daunt Books browsers. Regent's Park joggers, dog walkers. Wallace Collection afternoon visitors quiet culture. Less frantic than Oxford Street one block south. Village atmosphere maintained. Feels more residential, local. People going about business gracefully.

WEEKENDS

Market Energy

Sundays transform. Farmers' Market 10am-2pm brings village alive. Fresh produce, organic eggs, pastries, cheeses, flowers, paella. Local favorite, only organic UK. Brunch queues Fischer's, Granger & Co. High Street busier, mix locals/day-trippers. Regent's Park packed families, picnickers, boating lake popular. Golden hour Marylebone Lane soft-focus version. Still maintains village charm, never feels overwhelming like tourist spots. Elegant energy.

WHO LIVES HERE

Affluent Families

Well-heeled locals, young professionals, affluent families. Big houses, big buggies. Georgian terraces, mansion blocks dozens flats, mews streets nestled between. Park Crescent white stuccoed terrace John Nash, exclusive private park access. Bentinck Mews popular. Residents value quality, independent spirit. Schools outstanding: Wetherby, Francis Holland, Queen's College. Mix established wealth, international residents, creative professionals appreciate village feel central location. Rent high, buy higher. Desirable location people all ages live. Everything walkable.

■ Transport

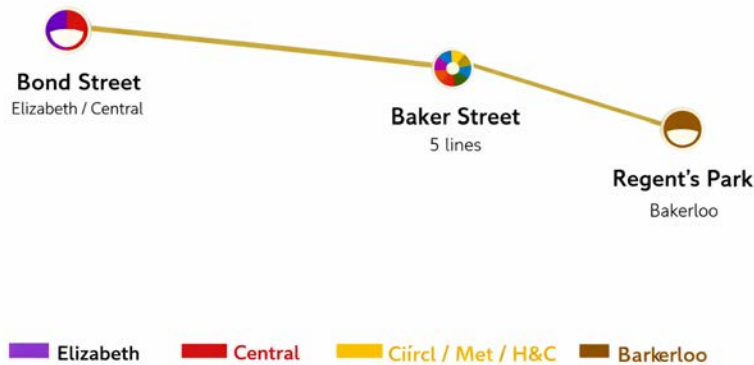

YOUR STATIONS

Bond Street

Elizabeth / Central / Jubilee

NEW Elizabeth line Heathrow/City 15 min. Central Oxford Circus. Most convenient High Street.

Baker Street

5 lines (Jubilee/Met/Bakerloo/Circle/H&C)

Major interchange. Direct routes across city. 10 min walk High Street. Connects everywhere.

Regent's Park

Bakerloo Line

Quick West End access. Northern edge village. Bakerloo Elephant & Castle / Paddington.

Marylebone Station

Mainline services

Oxford, Birmingham, UK destinations. Great Portland Street Tube nearby (Met/Circle/H&C).

■■ COMMUTE TIMES

Heathrow Airport - 15 min Elizabeth line

Direct Bond Street. Game-changer connections.

City/Bank - 10-15 min

Elizabeth/Central. Financial district easy.

Oxford Circus - 5 min walk / 1 stop

Literally neighboring. Shopping capital adjacent.

King's Cross - 10 min

Multiple route options. St Pancras Eurostar.

Canary Wharf - 20 min

Elizabeth line direct. Docklands easy.

■ WALKABILITY

Everything within walking distance. Pedestrian-friendly layout. Well-maintained streets. Santander Cycles available. Can walk almost everywhere - that's the point.

Fewer cars, stone streets, village feel preserved.

Walk Mayfair/Hyde Park/Fitzrovia/Regent's Park.

■ ■ Best Streets

Marylebone High Street

The Village Spine

Heart village. Dapper thoroughfare photo-worthy facades. Independent boutiques, coffee shops, florists, luxury favorites Aesop/Conran Shop/White Company. Tree-lined, clean lines, smart facades, subtle lived-in luxury London does best. Daunt Books 1912 Edwardian gem. Fischer's Viennese cafe. Ottolenghi deli. Nordic Bakery cinnamon buns. Most beloved shopping streets London. Everything need walking distance village charm maintained.

Marylebone Lane

The Winding Path

Narrow gently curving cut-through refuses behave like grid. Cafe chatter, perfume drifting doorways. Path original stream Tyburn medieval days, waterway covered over curve remains. Slip off High Street catch intimate village feel. Ottolenghi here too. 28°-50° wine bar. Historic character winding unpredictable. Finish golden hour soft-focus version.

Chiltern Street

The Scene

One Marylebone's most photographed streets. Red-brick Victorian buildings, stylish shops. Chiltern Firehouse celebrity magnet, scene-y. The Hart moody corner spot Public House Group. Blandford Street intersection. Mix residential/commercial perfect. Elegant boutiques, upscale dining. Where see/be seen crowd gravitates.

Moxon Street

Tiny But Mighty

Food shops turn 'I'll just look' into full grocery situation. La Fromagerie cheese heaven shop + cafe. Ginger Pig butcher. Artisan producers. Tiny street huge impact. Gourmands paradise. Quality over quantity embodied.

Blandford Street

Dining Row

Trishna Michelin Indian. Fairuz Lebanese rustic candlelight. Donostia Basque pintxos. Fine dining concentration impressive. Just off High Street, calmer, more intimate. Where serious food lovers come.

Marylebone Village area

Georgian Charm

Mansion blocks, mews streets, Georgian terraces. Park Crescent white stucco John Nash semi-circle exclusive private park. Bentinck Mews popular. Period properties, residential calm, village preserved central location. Big houses leafy squares, old-world elegance modern London life balanced perfectly.



Village Identity

Not accident - long-term estate stewardship keeps cohesive/pretty/low vacancy. Edited not algorithmic. Cozy European village within city steps Selfridges. Stone streets, fewer cars, quiet residential, old European charm. Local favorite largely unknown tourists. Daunt Books 1912, Nordic Bakery, independent spirit preserved. Howard de Walden Estate maintains character quality.



Regent's Park Access

Short stroll north nearly 400 acres luxurious green. Arguably prettiest Royal Parks. 12,000+ roses Queen Mary's Gardens. Boating lake, Primrose Hill views, Open Air Theatre. Morning jogs, picnics, autumn golden leaves. One London's most beautiful outdoor spaces 10-minute walk. Green space luxury Zone 1 rare.

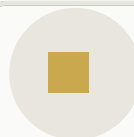

Michelin Density

High concentration Michelin stars fashionable West End corner. AngloThai 2025, Trishna coastal Indian, Kol Mexican. Fine dining + relaxed neighbourhood restaurants + hot new openings side by side. Whether haute cuisine or down-to-earth fare, absolutely great. Swanky district doesn't mean boring/overpriced - exceptional quality.

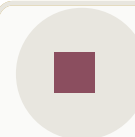

Independent Shopping

Daunt Books world's oldest custom-built bookshop 1912 paradise. White Company British linens. Whistles born here laid-back meets luxury. Conran Shop famous furniture. Independent boutiques not chains. Curated relaxed high-energy neighborhoods. Sunday Farmers' Market only organic UK produce 10am-2pm local beloved. Shopping edited quality individuality.

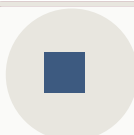

Cultural Treasures

Wallace Collection FREE world's greatest art 25 galleries French paintings/furniture/armour. Hals Laughing Cavalier, Rembrandt, Fragonard The Swing. Human-scale people return. Wigmore Hall 550-seat legendary acoustics chamber music. Quieter alternatives big museums, less touristy cultural experience. Historic townhouse + intimate performance space.

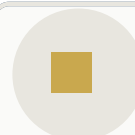

Transport Hub

Bond Street Elizabeth line Heathrow 15 min game-changer. Baker Street 5 lines major interchange. Regent's Park Bakerloo. Marylebone Station mainline Oxford/Birmingham. Everything walkable yet perfectly connected. Oxford Circus 5-min walk. City 10-15 min. Central location doesn't sacrifice village calm.

Village in the city. Central in the village.

Explore Marylebone.

[HOMES FOR SALE](#)

[HOMES TO RENT](#)

[GET A VALUATION](#)

[ASK OMAR](#)

CUI

CITY & URBAN INTERNATIONAL