

CUI

CITY & URBAN INTERNATIONAL

High Road, Chadwell Heath, RM6

£1,750 pcm



Full Description

A fantastic, two double bedroom two bathroom apartment Located moments from Chadwell heath station Rm6. This brilliant two bedroom apartment finished to a very high spec comes with an open plan lounge with fully integrated kitchen, including dishwasher, microwave and washer/dryer. The apartment has two double bedrooms with two bathrooms (one en-suite) The building has a great concierge service, lift access and has a huge communal roof terrace with fantastic views of central London. The apartment also comes with a private underground parking space.

Available unfurnished from 13th July

Features

- Private Parking space
- Concierge
- Communal roof terrace
- Two bathrooms (one en-suite)
- Available unfurnished from 13th July

Contact Us

CUI

25 Phipp Street, London
EC2A 4NP

T: 02077293344

E: shoreditch@cityandurban.com





Energy Efficiency Rating

	Current	Potential
Very energy efficient - lower running costs		
(92-100) A		
(81-91) B		
(69-80) C	82	82
(55-68) D		
(39-54) E		
(21-38) F		
(1-20) G		
Not energy efficient - higher running costs		

England, Scotland & Wales

EU Directive
2002/91/EC

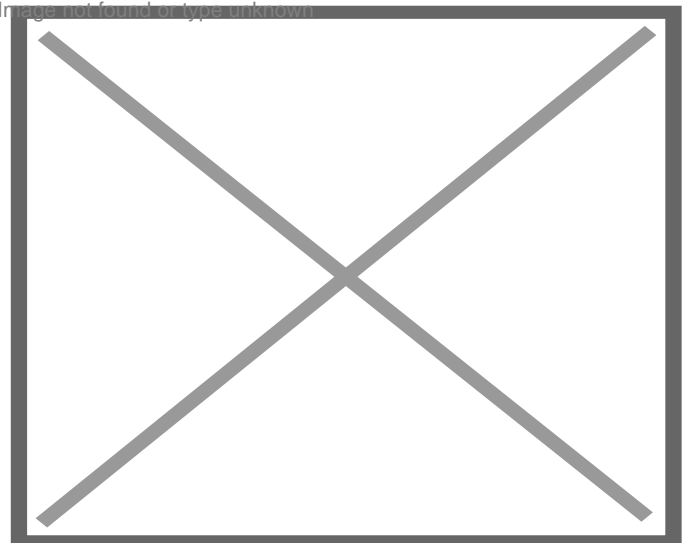

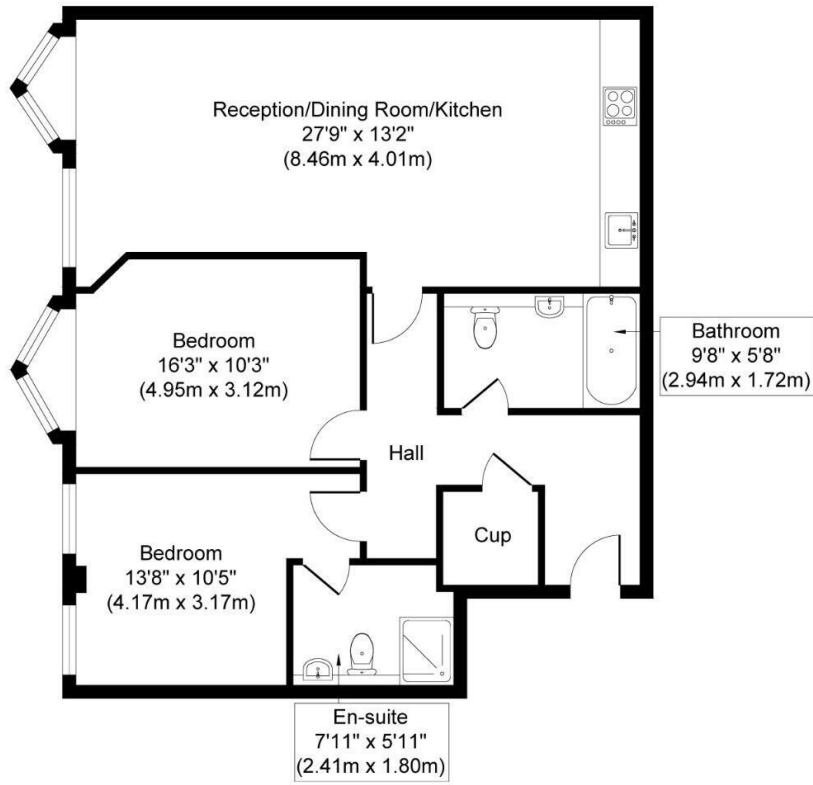

Approximate Floor Area
881 sq. ft
(81.89 sq. m)

Whilst every attempt has been made to ensure the accuracy of the floor plan contained here, measurements of doors, windows, rooms and any other items are approximate and no responsibility is taken for any error, omission, or mis-statement. The measurements should not be relied upon for valuation, transaction and/or funding purposes. This plan is for illustrative purposes only and should be used as such by any prospective purchaser or tenant. The services, systems and appliances shown have not been tested and no guarantee as to their operability or efficiency can be given.