

CUI

CITY & URBAN INTERNATIONAL

Crawford Place, London, W1H

£2,650 pcm



Full Description

We are delighted to present newly refurbished one bedroom lower ground floor apartment now available to rent. Finished to a high standard throughout, the property benefits from modern fixtures and fitting and under floor heating.

Excellent Opportunity to secure a viewing.
Available now

Contact Us

CUI

25 Phipp Street, London
EC2A 4NP

T: 02077293344

E: shoreditch@cityandurban.com



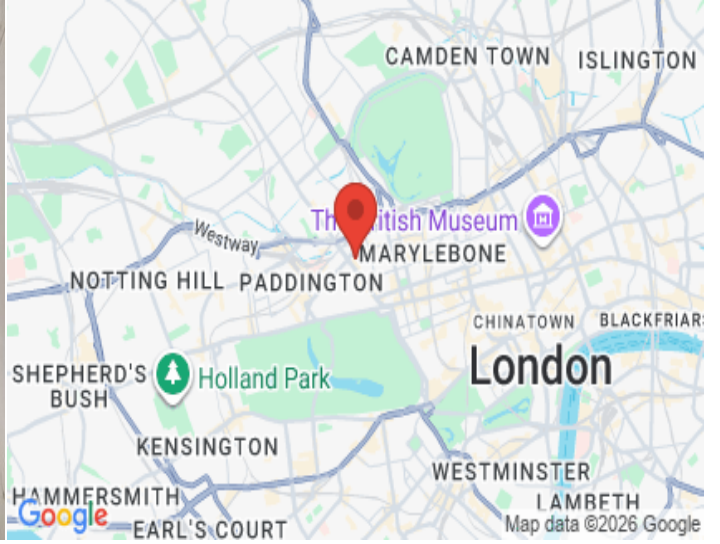

Crawford Place, W1H 5NW

Approx Gross Internal Area = 36.63 sq m / 394 sq ft

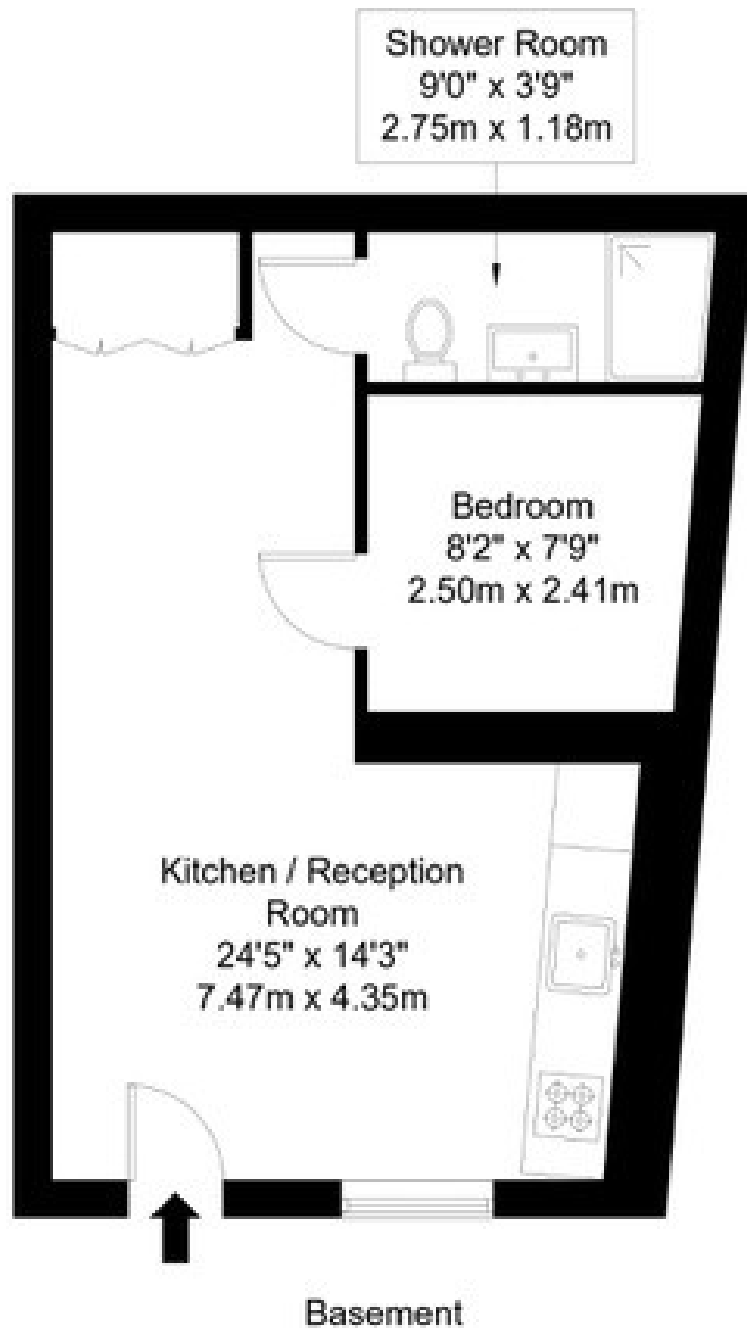

Ref :

Copyright

**B L E U
P L A N**

The Floor plan is not to scale and measurements and areas shown are approximate and therefore should be used for illustrative purposes only. The plan has been prepared in accordance with the RICS code of Measuring Practice and whilst we have confidence in the information produced it must not be relied on. Maximum lengths and widths are represented on the floor plan. If there is any aspect of particular importance, you should carry out or commission your own inspection of the property.

Copyright @ BLEUPLAN